

Watertight Male Plug

60A 240VAC

Catalog No: E634MP2A

Item No: 1800-04PA

Features



- UL Listed pin and sleeve male plug
- Heavy duty watertight design for marine environment
- One termination set screw per pole in backloaded contact carrier for easy assembly

Drawing

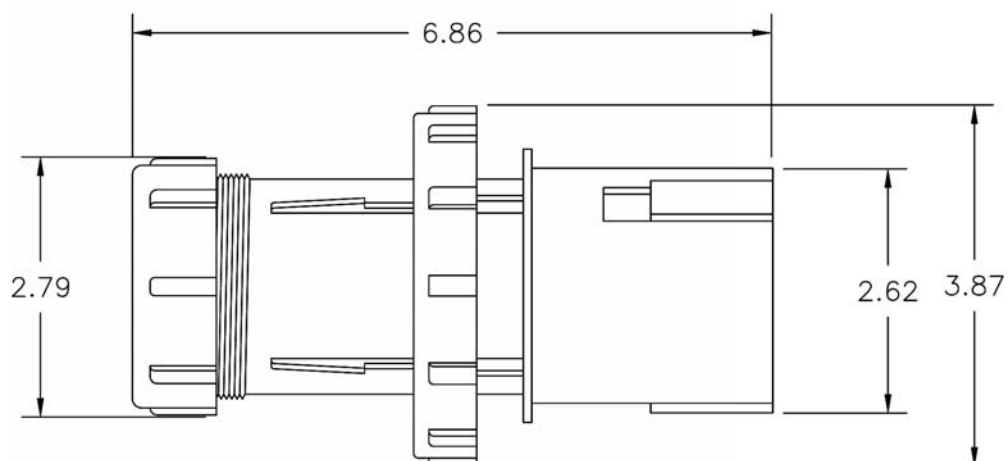

Approvals

- UL & cUL Listed

Specifications

Catalog No: E634MP2A

Item No: 1800-04PA

Ratings

Electrical	60A 240VAC pin & sleeve (240VAC 50/60 Hz) 3 phase 3 wire + ground
Cable range	Special grommet, consult factory
Environmental	Watertight
Terminals	(3) Phase & (1) ground pressure type screw terminals (1 per pole) accept #8-#6 AWG (10-16mm ²) conductors

Materials

Polyamide	Body, lock ring, gland ring, inner sleeve
Phenolic	Insert
Brass	Contact pins
Polychloroprene	Gaskets, grommet
Buna-N (Nitrile/NBR)	O-rings
Stainless steel	Gland clamp

Packaging

Approx. product weight	1 lb. (ea)
Approx. shipping weight	10 lbs. (carton of 10)
Approx. shipping dimensions	17in x 8in x 8in (carton of 10)