

# Flanged Connector

60A 480VAC  
 Catalog No: CF60SN-480-SP  
 Item No: 1910-07N

## Features



- Heavy-duty design for intermodal applications, shipboard, rail or over-road
- For use as an in-line connector or can be equipment-mounted using extra long bolts provided
- Developed specifically for the severe punishment of underslung gen-set applications, mounted on gen-set or directly to trailer chassis
- Stainless steel self-aligning snap cover
- Watertight screw cover optional

## Drawing

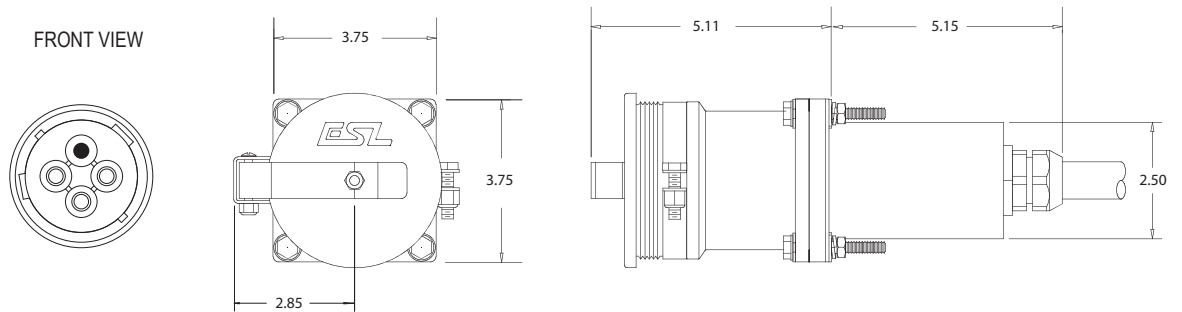

## Specifications

Catalog No: CF60SN-480-SP  
Item No: 1910-07N

### Ratings

Electrical	60A 480VAC pin & sleeve 3 phase 3 wire + ground
Cable range	0.71-1.02in (18 - 26mm) diameter
Environmental	Watertight
Terminals	(3) Phase & (1) ground pressure type 1/4-28 screw terminals (2 per pole) accept #6 - #10 AWG (13-5mm <sup>2</sup> ) 4 conductor cord

### Materials

Stainless steel	Rear housing, terminal screws, snap cover and all fasteners
Rynite	Insert
Nickel plated brass	Contact sleeves
Neoprene	Gaskets
Polymide	Receptacle housing
Buna-N (Nitrile/NBR)	O-rings

### Packaging

Approx. product weight	5 lbs. (ea)
Approx. shipping weight	50 lbs. (carton of 10)
Approx. shipping dimensions	17in x 8in x 8in (carton of 10)